

## M23 Power Molded Cable, Straight, Male Thread

- Connector series: M23 Power
- Contacts: Pin
- Mounting type: Straight
- Shielding: Shielded or unshielded
- Connection Type: Crimp
- Part No.: M23-MPSPST\*\*\*-XXXX (unshielded)  
M23-MPSSPST\*\*\*-XXXX (shielded)

\*\*\* refers to pins number  
XXXX refers to cable specification

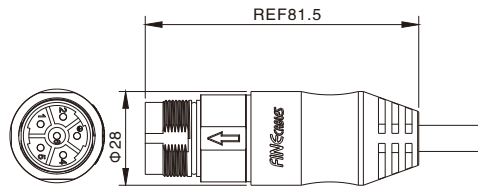

### General information



Connector overmold:	TPU
Connector insert:	PA
Connector contacts:	Brass with gold plated
Coupling screw:	Zinc alloy with nickel plated
Seal / O-ring:	FKM or NBR
Operation cycles:	>800

Insulation resistance:	$\geq 1000\text{M}\Omega$
Contact resistance:	$\leq 5\text{m}\Omega$
Ambient temperature:	-40°C ~ +80°C (fixed installation) -20°C ~ +80°C (flexible installation)
IP rating:	IP68 in locked condition
Cable OD range:	2.0~13

### Electrical data & Mechanical data

Number of positions	6(5+PE)	8(4+3+PE)		
Contacts	5+PE	4	3	PE
Contact OD(mm)	2.0(0.25~4.0mm <sup>2</sup> )	1.0(0.08~1.0mm <sup>2</sup> )	2.0(0.25~4.0mm <sup>2</sup> )	
Rated current @ 20°C(A)	30	9	30	
Rated Voltage(V)	630	250	630	
Impulse voltage(V)	6000	4000	6000	
Overvoltage category	II			
Pollution Degree	III			

Contacts	Contact OD (mm)	Pin	Part No.	Contacts	Contact OD (mm)	Pin	Part No.
06 (5+PE)	2		M23-MPSPST06A-XXXX (unshielded)	08 (4+3+PE)	2		M23-MPSPST08A-XXXX (unshielded)
			M23-MPSSPST06A-XXXX (shielded)				M23-MPSSPST08A-XXXX (shielded)
					4	1	

Note: X refers to cable specification

### Remarks

- Please refer to Page 578 for the Conversion between American Wire Gauge AWG and Wire Cross-section mm<sup>2</sup>.
- Please refer to Page 365 for products' part number encoding rule.

## M23 Power Molded Cable, Straight, Female Thread

- Connector series: M23 Power
- Contacts: Socket
- Mounting type: Straight
- Shielding: Shielded or unshielded
- Connection Type: Crimp
- Part No.: M23-MPNSST\*\*\*-XXXX (unshielded)  
M23-MPNSST\*\*\*-XXXX (shielded)

\*\*\* refers to pins number  
XXXX refers to cable specification

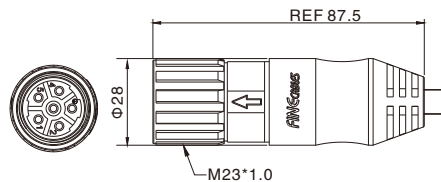

### General information



Connector overmold:	TPU
Connector insert:	PA
Connector contacts:	Brass with gold plated
Coupling screw:	Zinc alloy with nickel plated
Seal / O-ring:	FKM or NBR
Operation cycles:	>800

Insulation resistance:	≥ 1000MΩ
Contact resistance:	≤ 5mΩ
Ambient temperature:	-40°C ~ +80°C (fixed installation) -20°C ~ +80°C (flexible installation)
IP rating:	IP68 in locked condition
Cable OD range:	2.0~13

### Electrical data & Mechanical data

Number of positions	6(5+PE)	8(4+3+PE)		
Contacts	5+PE	4	3	PE
Contact OD(mm)	2.0(0.25~4.0mm <sup>2</sup> )	1.0(0.08~1.0mm <sup>2</sup> )	2.0(0.25~4.0mm <sup>2</sup> )	
Rated current @ 20°C(A)	30	9	30	
Rated Voltage(V)	630	250	630	
Impulse voltage(V)	6000	4000	6000	
Overvoltage category	II			
Pollution Degree	III			

Contacts	Contact OD (mm)	Socket	Part No.	Contacts	Contact OD (mm)	Socket	Part No.
06 (5+PE)	2		M23-MPNSST06A-XXXX (unshielded) M23-MPNSST06A-XXXX (shielded)	08 (4+3+PE)	2		M23-MPNSST08A-XXXX (unshielded) M23-MPNSST08A-XXXX (shielded)
					1		

Note: X refers to cable specification

### Remarks

- Please refer to Page 578 for the Conversion between American Wire Gauge AWG and Wire Cross-section mm<sup>2</sup>.
- Please refer to Page 365 for products' part number encoding rule.

## M23 Power Molded Cable, Right Angle, Male Thread

- Connector series: M23 Power
- Contacts: Pin
- Mounting type: Right Angle
- Shielding: Shielded or unshielded
- Connection Type: Crimp
- Part No.: M23-MPSRA\*\*\*-XXXX (unshielded)  
M23-MPSSRA\*\*\*-XXXX (shielded)

\*\*\* refers to pins number  
XXXX refers to cable specification

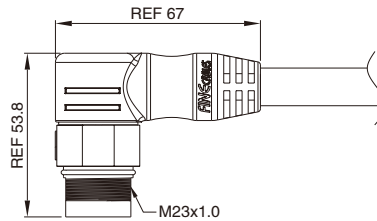

### General information



Connector overmold:	TPU
Connector insert:	PA
Connector contacts:	Brass with gold plated
Coupling screw:	Zinc alloy with nickel plated
Seal / O-ring:	FKM or NBR
Operation cycles:	>800

Insulation resistance:	≥ 1000MΩ
Contact resistance:	≤ 5mΩ
Ambient temperature:	-40°C ~ +80°C (fixed installation) -20°C ~ +80°C (flexible installation)
IP rating:	IP68 in locked condition
Cable OD range:	2.0~13

### Electrical data & Mechanical data

Number of positions	6(5+PE)	8(4+3+PE)		
Contacts	5+PE	4	3	PE
Contact OD(mm)	2.0(0.25~4.0mm <sup>2</sup> )	1.0(0.08~1.0mm <sup>2</sup> )	2.0(0.25~4.0mm <sup>2</sup> )	
Rated current @ 20°C(A)	30	9	30	
Rated Voltage(V)	630	250	630	
Impulse voltage(V)	6000	4000	6000	
Overvoltage category	II			
Pollution Degree	III			

Contacts	Contact OD (mm)	Pin	Part No.	Contacts	Contact OD (mm)	Pin	Part No.
06 (5+PE)	2		M23-MPSRA06A-XXXX (unshielded)	08 (4+3+PE)	2		M23-MPSRA08A-XXXX (unshielded)
			M23-MPSSRA06A-XXXX (shielded)				M23-MPSSRA08A-XXXX (shielded)
					1		

Note: X refers to cable specification

### Remarks

- Please refer to Page 578 for the Conversion between American Wire Gauge AWG and Wire Cross-section mm<sup>2</sup>.
- Please refer to Page 365 for products' part number encoding rule.

## M23 Power Molded Cable, Right Angle, Female Thread

- Connector series: M23 Power
- Contacts: Socket
- Mounting type: Right Angle
- Shielding: Shielded or unshielded
- Connection Type: Crimp
- Part No.: M23-MPNSRA\*\*\*-XXXX (unshielded)  
M23-MPNSRA\*\*\*-XXXX (shielded)

\*\*\* refers to pins number  
XXXX refers to cable specification

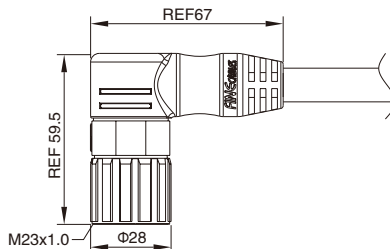

### General information



Connector overmold:	TPU
Connector insert:	PA
Connector contacts:	Brass with gold plated
Coupling screw:	Zinc alloy with nickel plated
Seal / O-ring:	FKM or NBR
Operation cycles:	>800

Insulation resistance:	≥ 1000MΩ
Contact resistance:	≤ 5mΩ
Ambient temperature:	-40°C ~ +80°C (fixed installation) -20°C ~ +80°C (flexible installation)
IP rating:	IP68 in locked condition
Cable OD range:	2.0~13

### Electrical data & Mechanical data

Number of positions	6(5+PE)	8(4+3+PE)		
Contacts	5+PE	4	3	PE
Contact OD(mm)	2.0(0.25~4.0mm <sup>2</sup> )	1.0(0.08~1.0mm <sup>2</sup> )	2.0(0.25~4.0mm <sup>2</sup> )	
Rated current @ 20°C(A)	30	9	30	
Rated Voltage(V)	630	250	630	
Impulse voltage(V)	6000	4000	6000	
Overvoltage category	II			
Pollution Degree	III			

Contacts	Contact OD (mm)	Socket	Part No.	Contacts	Contact OD (mm)	Socket	Part No.
06 (5+PE)	2		M23-MPNSRA06A-XXXX (unshielded)	08 (4+3+PE)	2		M23-MPNSRA08A-XXXX (unshielded)
			M23-MPNSRA06A-XXXX (shielded)				M23-MPNSRA08A-XXXX (shielded)
				4	1		

Note: X refers to cable specification

### Remarks

- Please refer to Page 578 for the Conversion between American Wire Gauge AWG and Wire Cross-section mm<sup>2</sup>.
- Please refer to Page 365 for products' part number encoding rule.

## M23 Power Assembly Connector, Straight, Male Thread

- Connector series: M23 Power
- Contacts: Pin
- Mounting type: Straight
- Shielding: Shielded
- Connection Type: Crimp
- Part No.: M23-PSSPST\*\*\*-XX  
 \*\*\* refers to pins number  
 XX for cable OD rang

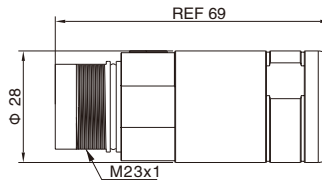

### General information



Connector insert:	PA
Connector contacts:	Brass with gold plated
Coupling nut/screw:	Zinc alloy with nickel plated
Connector body:	Zinc alloy with nickel plated
Seal / O-ring:	FKM or NBR
Operation cycles:	>800

Insulation resistance:	≥ 1000MΩ
Contact resistance:	≤ 5mΩ
Ambient temperature:	-40°C ~ +125°C
IP rating:	IP68 in locked condition
Cable OD range:	2.0~16
Assembly Instruction:	Refer to page 417

### Electrical data & Mechanical data

Number of positions	6(5+PE)	8(4+3+PE)		
Contacts	5+PE	4	3	PE
Contact OD(mm)	2.0(0.25~4.0mm <sup>2</sup> )	1.0(0.08~1.0mm <sup>2</sup> )	2.0(0.25~4.0mm <sup>2</sup> )	
Rated current @ 20°C(A)	30	9	30	
Rated Voltage(V)	630	250	630	
Impulse voltage(V)	6000	4000	6000	
Overvoltage category	II			
Pollution Degree	III			

Contacts	Contact OD (mm)	Pin	Part No.	Contacts	Contact OD (mm)	Pin	Part No.
06 (5+PE)	2		M23-PSSPST06A-XX	08 (4+3+PE)	2		M23-PSSPST08A-XX
					4		

Note: X for cable OD rang

### Remarks

- Please refer to Page 578 for the Conversion between American Wire Gauge AWG and Wire Cross-section mm<sup>2</sup>.
- Please refer to Page 366 for products' part number encoding rule.

## M23 Power Assembly Connector, Straight, Female Thread

- Connector series: M23 Power
- Contacts: Socket
- Mounting type: Straight
- Shielding: Shielded
- Connection Type: Crimp
- Part No.: M23-PNSSST\*\*\*-XX  
 \*\*\* refers to pins number  
 XX for cable OD rang

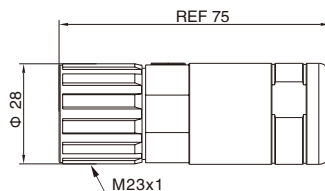

### General information



Connector insert:	PA
Connector contacts:	Brass with gold plated
Coupling nut/screw:	Zinc alloy with nickel plated
Connector body:	Zinc alloy with nickel plated
Seal / O-ring:	FKM or NBR
Operation cycles:	>800

Insulation resistance:	≥ 1000MΩ
Contact resistance:	≤ 5mΩ
Ambient temperature:	-40°C ~ +125°C
IP rating:	IP68 in locked condition
Cable OD range:	2.0~16
Assembly Instruction:	Refer to page 417

### Electrical data & Mechanical data

Number of positions	6(5+PE)	8(4+3+PE)		
Contacts	5+PE	4	3	PE
Contact OD(mm)	2.0(0.25~4.0mm <sup>2</sup> )	1.0(0.08~1.0mm <sup>2</sup> )	2.0(0.25~4.0mm <sup>2</sup> )	
Rated current @ 20°C(A)	30	9	30	
Rated Voltage(V)	630	250	630	
Impulse voltage(V)	6000	4000	6000	
Overvoltage category	II			
Pollution Degree	III			

Contacts	Contact OD (mm)	Socket	Part No.	Contacts	Contact OD (mm)	Socket	Part No.
06 (5+PE)	2		M23-PNSSST06A-XX	08 (4+3+PE)	2		M23-PNSSST08A-XX
				4	1		

Note: X for cable OD rang

### Remarks

- Please refer to Page 578 for the Conversion between American Wire Gauge AWG and Wire Cross-section mm<sup>2</sup>.
- Please refer to Page 366 for products' part number encoding rule.

## M23 Power, Panel Mount, Crimp, Male Thread

- Connector series: M23 Power
- Contacts: Pin
- Mounting type: Front mount
- Shielding: Unshielded
- Connection Type: Crimp
- Part No.: M23-PSPSTFFx\*\*\*-XXXX

Fx refer to Flange joint  
 \*\*\* refers to pins number  
 XXXX refers to cable specs

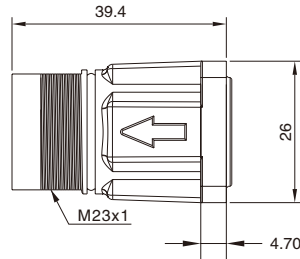

### General information



Connector insert:	PA
Connector contacts:	Brass with gold plated
Coupling nut/screw:	Zinc alloy with nickel plated
Connector body:	Zinc alloy with nickel plated
Seal / O-ring:	FKM or NBR
Operation cycles:	>800

Insulation resistance:	≥ 1000MΩ
Contact resistance:	≤ 5mΩ
Ambient temperature:	-40°C ~ +125°C
IP rating:	IP68 in locked condition
Assembly Instruction:	Refer to page 418

### Electrical data & Mechanical data

Number of positions	6(5+PE)	8(4+3+PE)		
Contacts	5+PE	4	3	PE
Contact OD(mm)	2.0(0.25~4.0mm <sup>2</sup> )	1.0(0.08~1.0mm <sup>2</sup> )	2.0(0.25~4.0mm <sup>2</sup> )	
Rated current @ 20°C(A)	30	9	30	
Rated Voltage(V)	630	250	630	
Impulse voltage(V)	6000	4000	6000	
Overvoltage category	II			
Pollution Degree	III			

Contacts	Contact OD (mm)	Pin	Part No.	Contacts	Contact OD (mm)	Pin	Part No.
06 (5+PE)	2		M23-PSPSTFFx06A-XXXX	08 (4+3+PE)	2		M23-PSPSTFFx08A-XXXX
					4	1	

Note: Fx refer to Flange joint, X refers to cable specs

### Remarks

- Please refer to Page 578 for the Conversion between American Wire Gauge AWG and Wire Cross-section mm<sup>2</sup>.
- Please refer to Page 367 for products' part number encoding rule.

## M23 Power, Panel Mount, Crimp, Female Thread

- Connector series: M23 Power
- Contacts: Socket
- Mounting type: Front mount
- Shielding: Unshielded
- Connection Type: Crimp
- Part No.: M23-PNSSTFFx\*\*\*-XXXX

Fx refer to Flange joint  
 \*\*\* refers to pins number  
 XXXX refers to cable specs

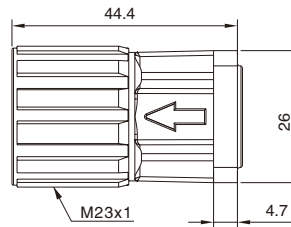

### General information



Connector insert:	PA
Connector contacts:	Brass with gold plated
Coupling nut/screw:	Zinc alloy with nickel plated
Connector body:	Zinc alloy with nickel plated
Seal / O-ring:	FKM or NBR
Operation cycles:	>800

Insulation resistance:	$\geq 1000\text{M}\Omega$
Contact resistance:	$\leq 5\text{m}\Omega$
Ambient temperature:	$-40^\circ\text{C} \sim +125^\circ\text{C}$
IP rating:	IP68 in locked condition
Assembly Instruction:	Refer to page 418

### Electrical data & Mechanical data

Number of positions	6(5+PE)	8(4+3+PE)		
Contacts	5+PE	4	3	PE
Contact OD(mm)	2.0(0.25~4.0mm <sup>2</sup> )	1.0(0.08~1.0mm <sup>2</sup> )	2.0(0.25~4.0mm <sup>2</sup> )	
Rated current @ 20°C(A)	30	9	30	
Rated Voltage(V)	630	250	630	
Impulse voltage(V)	6000	4000	6000	
Overvoltage category	II			
Pollution Degree	III			

Contacts	Contact OD (mm)	Socket	Part No.	Contacts	Contact OD (mm)	Socket	Part No.
06 (5+PE)	2		M23-PNSSTFFx06A-XXXX	08 (4+3+PE)	2		M23-PNSSTFFx08A-XXXX
				4	1		

Note: Fx refer to Flange joint, X refers to cable specs

### Remarks

- Please refer to Page 578 for the Conversion between American Wire Gauge AWG and Wire Cross-section mm<sup>2</sup>.
- Please refer to Page 367 for products' part number encoding rule.



## M23 Power, Panel Mount, Crimp, Male Thread, Right Angle Connector

- Connector series: M23 Power
- Contacts: Pin
- Mounting type: Right Angle, Front mount
- Shielding: Unshielded
- Connection Type: Crimp
- Part No.: M23-PSPRAFFx\*\*\*-XXXX

Fx refer to Flange joint  
 \*\*\* refers to pins number  
 XXXX refers to cable specs

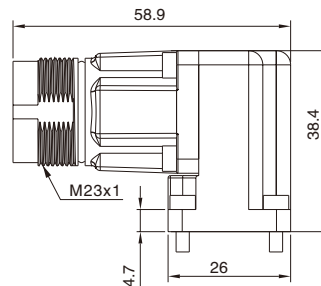

### General information



Connector insert:	PA
Connector contacts:	Brass with gold plated
Coupling nut/screw:	Zinc alloy with nickel plated
Connector body:	Zinc alloy with nickel plated
Seal / O-ring:	FKM or NBR
Operation cycles:	>800

Insulation resistance:	≥ 1000MΩ
Contact resistance:	≤ 5mΩ
Ambient temperature:	-40°C ~ +125°C
IP rating:	IP68 in locked condition
Assembly Instruction:	Refer to page 419

### Electrical data & Mechanical data

Number of positions	6(5+PE)	8(4+3+PE)		
Contacts	5+PE	4	3	PE
Contact OD(mm)	2.0(0.25~4.0mm <sup>2</sup> )	1.0(0.08~1.0mm <sup>2</sup> )	2.0(0.25~4.0mm <sup>2</sup> )	
Rated current @ 20°C(A)	30	9	30	
Rated Voltage(V)	630	250	630	
Impulse voltage(V)	6000	4000	6000	
Overvoltage category	II			
Pollution Degree	III			

Contacts	Contact OD (mm)	Pin	Part No.	Contacts	Contact OD (mm)	Pin	Part No.
06 (5+PE)	2		M23-PSPRAFFx06A-XXXX	08 (4+3+PE)	2		M23-PSPRAFFx08A-XXXX
				4	1		

Note: Fx refer to Flange joint, X refers to cable specs

### Remarks

- Please refer to Page 578 for the Conversion between American Wire Gauge AWG and Wire Cross-section mm<sup>2</sup>.
- Please refer to Page 367 for products' part number encoding rule.

## M23 Power ,Panel Mount, Crimp, Female Thread, Right Angle Connector

- Connector series: M23 Power
- Contacts: Socket
- Mounting type: Right Angle, Front mount
- Shielding: Unshielded
- Connection Type: Crimp
- Part No.: M23-PNSRAFFx\*\*\*-XXXX

Fx refer to Flange joint  
 \*\*\* refers to pins number  
 XXXX refers to cable specs

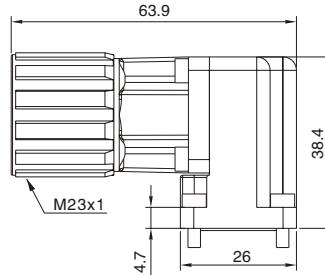

### General information



Connector insert:	PA
Connector contacts:	Brass with gold plated
Coupling nut/screw:	Zinc alloy with nickel plated
Connector body:	Zinc alloy with nickel plated
Seal / O-ring:	FKM or NBR
Operation cycles:	>800

Insulation resistance:	$\geq 1000\text{M}\Omega$
Contact resistance:	$\leq 5\text{m}\Omega$
Ambient temperature:	$-40^{\circ}\text{C} \sim +125^{\circ}\text{C}$
IP rating:	IP68 in locked condition
Assembly Instruction:	Refer to page 419

### Electrical data & Mechanical data

Number of positions	6(5+PE)	8(4+3+PE)		
Contacts	5+PE	4	3	PE
Contact OD(mm)	2.0(0.25~4.0mm <sup>2</sup> )	1.0(0.08~1.0mm <sup>2</sup> )	2.0(0.25~4.0mm <sup>2</sup> )	
Rated current @ 20°C(A)	30	9	30	
Rated Voltage(V)	630	250	630	
Impulse voltage(V)	6000	4000	6000	
Overvoltage category	II			
Pollution Degree	III			

Contacts	Contact OD (mm)	Socket	Part No.	Contacts	Contact OD (mm)	Socket	Part No.
06 (5+PE)	2		M23-PNSRAFFx06A-XXXX	08 (4+3+PE)	2		M23-PNSRAFFx08A-XXXX
				4	1		

Note: Fx refer to Flange joint, X refers to cable specs

### Remarks

- Please refer to Page 578 for the Conversion between American Wire Gauge AWG and Wire Cross-section mm<sup>2</sup>.
- Please refer to Page 367 for products' part number encoding rule.